



A WORLD LEADER IN FUME EXTRACTION TECHNOLOGY

# 3D PrintPRO 4

Last Updated on 02.02.2022



For large format and high-performance 3D printers

The refreshed BOFA 3D PrintPRO 4 provides a premium fume extraction solution for high performing 3D printers. With a special blend of chemical adsorbents and high efficiency particulate filter (HEPA), the extractor delivers protection against emissions from 3D printing processes.

Print your own connectors and extendable manifolds 3D drawing files can be found at: [donaldsonbofa.com/print-your-own/](http://donaldsonbofa.com/print-your-own/)

## Technology



HEPA filter



Advanced carbon filter (ACF) technology



Multi voltage sensing (MVS) unit



ProTECT service plan



SureCHECK quality standard

## Key features of the 3D PrintPRO 4

Multi layer filtration - HEPA and gas filters  
Standard

Low noise level  
Standard

Filter change indicator  
Standard

Auto sensing voltage (100-230v) for global use  
Standard

24V remote stop / start interface  
Optional

Gas sensing technology  
Optional

Extended life filters for low cost of ownership  
Standard

Compact construction  
Standard

Lockable castors  
Standard

UL / CE approvals  
Standard

Filter status signals to host machine  
Optional

Silencer box with spigot  
Optional

## Technical specification

- 1. Digital speed control
- 5. Lid fastening latches

- 2. On / off switch
- 6. Handles

- 3. Filter condition display
- 7. Hose inlet connections - 75mm

- 4. Power cable inlet
- 8. Exhaust outlet

Contact BOFA at [www.donaldsonbofa.com/contact/](http://www.donaldsonbofa.com/contact/)  
[www.donaldsonbofa.com/fume-extraction-systems/3d-printpro-4/](http://www.donaldsonbofa.com/fume-extraction-systems/3d-printpro-4/)



Approvals: REACH and RoHS. See individual product technical data for specific accreditations

9. Castors

10. Override switch

11. Signal interface

12. Optional silencer box with spigot

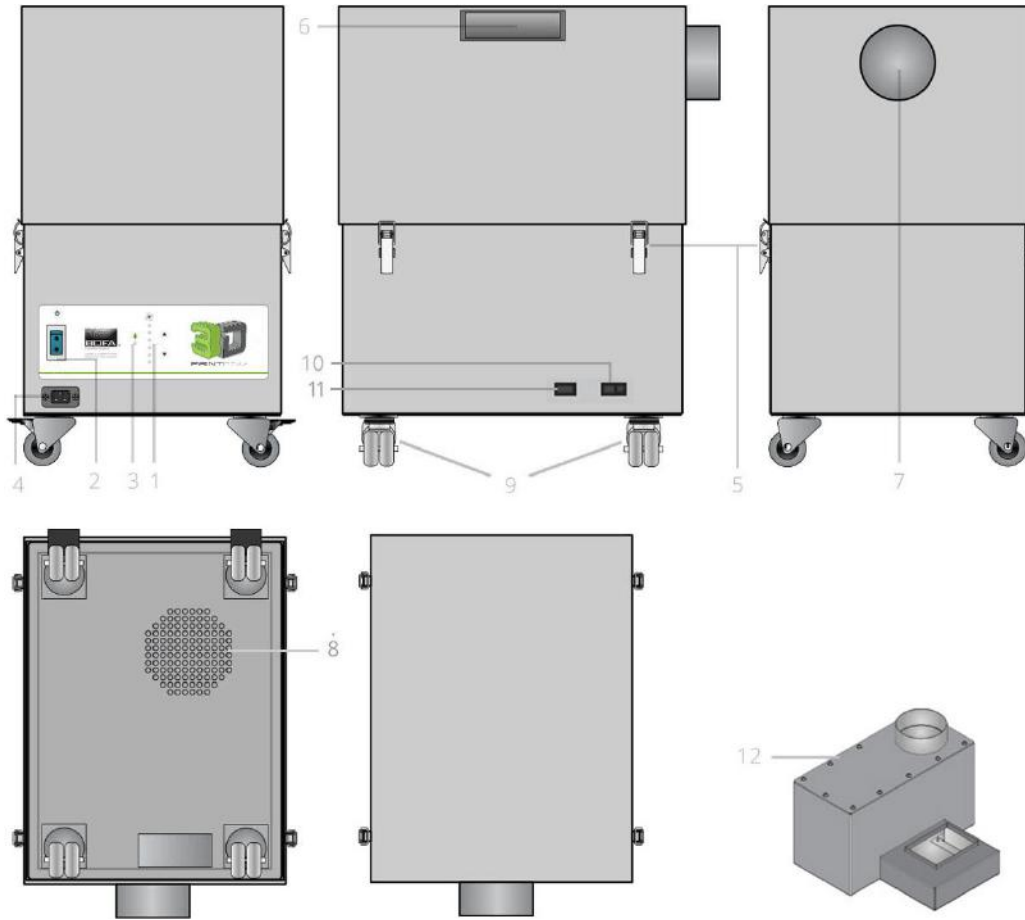

### Airflow through filters

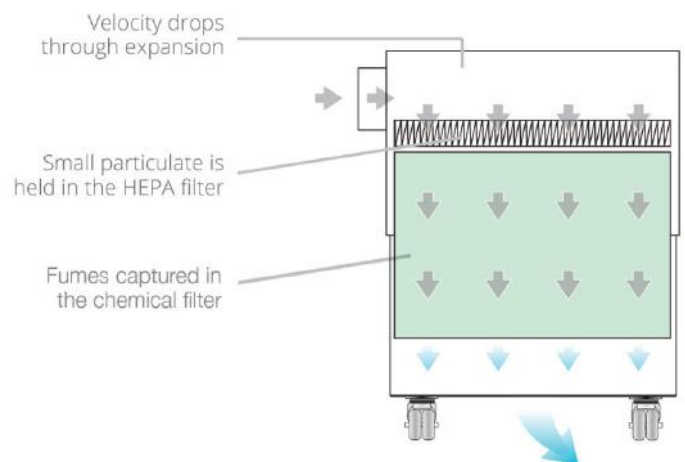
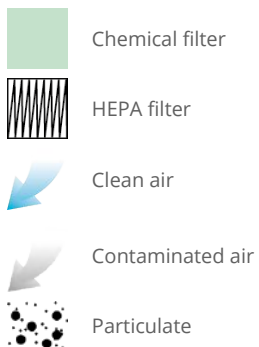

### Technical data

|                      | EU                       | US                       |
|----------------------|--------------------------|--------------------------|
| Dimensions (HxWxD)   | 625 x 385 x 525          | 24.60 x 15.16 x 20.67"   |
| Cabinet construction | Powder coated mild steel | Powder coated mild steel |

## Technical data

|                          |   |   |
|--------------------------|---|---|
| Min airflow              | 50m³/hr                                 | 30cfm                                   |
| Max airflow              | 270m³/hr                                | 159cfm                                  |
| Maximum available vacuum | 100 mBar                                | 100 mBar                                |
| Electrical data          | 230v 50/60Hz Full load current: 8.8amps | 115v 60/50Hz Full load current: 9.5amps |
| Noise level              | < 75dBA (at typical operating speed)    | < 75dBA (at typical operating speed)    |
| Weight                   | 51kgs                                   | 113lbs                                  |
| Approvals                | UKCA / CE                               | cUL / UL*                               |

## HEPA / gas filter specification

|                                |  |
|--------------------------------|--|
| Treated activated carbon blend | 10.6kg approx (23lbs)  |
| Other adsorbents               | 5kg approx (11lbs)   |
| Particulate filter media       | Borosilicate   |
| Particulate media construction | 50mm maxi pleat construction with glue bead spacers (0.16ft) |
| Filter housing                 | Zintec mild steel  |
| Media surface area             | 3.5m² approx (37.66ft²)                                      |
| Filter efficiency              | 99.997% @ 0.3µms   |

## Unit part numbers

| Model         | Powder coated | OPTION: 24V start / stop + override | OPTION: Filter condition signal | OPTION: VOC sensor | Part number   |
|---------------|---------------|-------------------------------------|---------------------------------|--------------------|---|
| 3D PrintPRO 4 | YES           | NO                                  | NO                              | NO                 | UK - 376002-2127<br>EU - 5376002-2127<br>US - 10376002-2127             |
| 3D PrintPRO 4 | YES           | YES                                 | YES                             | YES                | UK - 12750376002-2127<br>EU - 12755376002-2127<br>US - 12760376002-2127 |

## Replacement filter part numbers

| Model         | Combined filter |
|---------------|-----------------|
| 3D PrintPRO 4 | A1030469        |

## Optional silencer box

| Model       | Silencer box with spigot |
|-------------|--------------------------|
| Part number | A1060052                 |

\* Tested to UL and cUL standards, but testing may be provided by alternate nationally recognised test laboratories. Certain product configurations may affect the UL certification. Please speak to your sales representative.

\*\*Premium filter is included as standard.

---

*Datasheet correct at time of publishing.*

*Where applicable, the carbon used in BOFA units is capable of removing a wide range of VOCs, however it is the responsibility of the user to ensure the carbon is suitable for their application. For specific applications, please contact us for details.*

**Important Notice:** *Many factors beyond the control of BOFA can affect the use and performance of BOFA products in a particular application, including the conditions under which the product is used. Since these factors are uniquely within the user's knowledge and control, it is essential the user evaluate the products to determine whether the product is fit for the particular purpose and suitable for the user's application. All products, product specifications, availability and data are subject to change without notice, and may vary by region or country.*

*Think before you print! Please consider the environment before printing this document.*

